



# St Giles Junior School

## January 2018

St Giles Junior School  
Hayes Lane, Exhall, Warwickshire, CV7 9NS  
Tel : 02476 313375  
Email : admin2571@welearn365.com

### Welcome back

It's hard to believe that January has been and gone, much like everyone's New Year resolutions? One thing we are not forgetting about though is about our school's attendance.

St Giles Junior School is committed to ensuring the best for all our learners and working together with parents to support children and families. We will be working hard to promote good attendance and have common systems in place to work with families if attendance drops below an acceptable level. Our Attendance Policy has been agreed by the school governors and can be found on the school website. It is important for the children's education that their attendance is above 95% and that children arrive in school on time. We hope you will continue supporting us with this.

### School Games Indoor Rowing Competition at Etone College

10 schools from Warwickshire took part in a North Warwickshire rowing competition.

All our rowers put in lots of effort to earn metres for their team. Everyone rowed over 150m in one minute. Fantastic as for most them it was the first time they had been on a rowing machine!

They also represented St. Giles admirably as their behaviour was wonderful and they encouraged and supported each other throughout the competition.

Please have a look at our new website and have a look at the video clip of the afternoon – it looks like great fun, they want a rowing machine in school now!

### Healthy Snacks, Please

Can we encourage you to make sure only healthy snacks are brought into school. We have a small number of children who are eating large chocolate bars etc. which we feel isn't appropriate.



**Ofsted Parent View** is Ofsted's on-line questionnaire that allows parents & carers to give their views on their child's school at any time of the year. The 12 questions were carefully chosen to ensure that they cover a range of issues which are important to parents.

**You can complete the questionnaire by logging onto <http://parentview.ofsted.gov.uk>**

## Football News

On Wednesday St Giles were involved in the Warwickshire Football Finals.

The weather wasn't the best, and the venue didn't allow our team the opportunity to show their free flowing style, but the team played really well. It went down to the last game, the National Finals were within touching distance, but we were narrowly beaten.

The team was very disappointed, but they must remember it was a fantastic achievement to get into the finals, and they were very close to winning it.

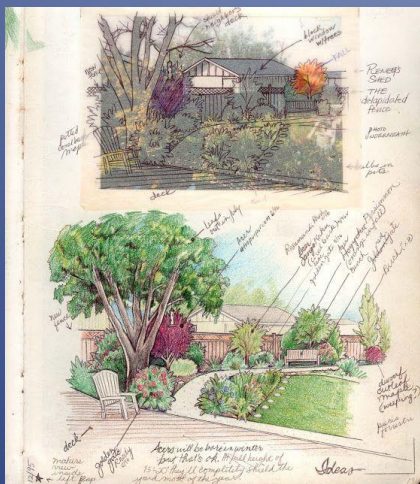

## Quad Clean Up

Reports coming back to us from the farms that have taken our pigs, chickens and ducks have all been positive. It's glad to see our animals behave as well as the students.

There is now the issue of what we do with the space they've left – The Quad. We have had a couple of landscape gardeners coming in to give us quotes for redesigning it. We want the space to be now available for the students to use, and they have already been asked to draw their plans and give them in.

If you know of any contacts that could come in as well, please leave their details with the office.

## If your Child Arrives Late

To make sure that your child is safe in the mornings, if they are arriving after 9.10am you will have to accompany them to the office. If they are a couple of minutes late they can enter the school by themselves via the main door. Thank you for your support with this.

## It's a Goodbye from Mrs Panesar

After over twenty years working as a Teaching Assistant at St Giles, Mrs Panesar is sadly leaving us.

We thank her for her years of dedication to our school and its community. We all wish her well, and hope to keep in contact.



For the moment we will be sending out alerts on both apps, but the new Schudio one will have all the extra content including calendar events. We will only use the old App you're using now for alerts, and it will stop next week.

The New Schudio App is available to everyone, and it's completely FREE! To get the Schudio App go to the App Store on your Apple device or the Google Play store on your Android device and search 'Schudio'.



Once you've downloaded the app it couldn't be simpler to use.

Open the app and you'll then have to sign up by pressing the 'Join Schudio' button. Enter your name, email and a password and press 'Join Now'. You'll then be prompted to select from the list of schools St Giles Junior School.

That's it! You're up and running on the Schudio App! On the App you'll be able to see News, Events and Announcements from the School you selected. It couldn't be simpler. Feel free to pass these instructions on to anyone who wishes to sign up for the free App.

We've had a parent from Hawkesbury Village asking if anyone is able to help out with lifts to and from school. If anyone is available can you leave your details with the office

### Office News

**School Dinners** – Payment is £2.15 per day, £10.75 per week, and they must be paid for in advance. AGORA is a convenient, flexible way to pay for dinners online. If you do not have an account in place, please contact the school office.

**Administering Medicine** – If your child needs to have medication whilst at school, please send in labelled medication with written confirmation of when and how much medication needs to be administered. Please make sure you sign and date it. This will ensure we have an accurate record of your instructions.

**Mobile Phones** – Plastic wallets have been introduced for mobile phones being brought into school. Thank you to all those using them as it speeds up the collection and distribution process at the start and end of the day.



## Parents and Carers' Events Calendar

### Spring Term 2017

Week commencing	Event
<b>1<sup>st</sup> Jan</b>	Fri 5 <sup>th</sup> : INSET Day – closed to students
<b>8<sup>nd</sup> Jan</b>	Mon 8 <sup>th</sup> : Children start back at school 8:45am start Monday 8 <sup>th</sup> : year 6 height and weight check by school nurse
<b>15<sup>th</sup> Jan</b>	Thur 18 <sup>th</sup> : Personal Safety Day Fri 19 <sup>th</sup> Feb: 5E Class assembly at 09:10am
<b>22<sup>th</sup> Jan</b>	Fri 26 <sup>th</sup> Feb: 5F Class assembly at 09:10am
<b>29<sup>rd</sup> Jan</b>	Wed 31 <sup>st</sup> : Travelling Book Fair arrives for 1 week. Fri 2 <sup>rd</sup> Feb: 4D Class assembly at 09:10am
<b>5<sup>th</sup> Feb</b>	Fri 9 <sup>th</sup> Feb: 4C Class assembly at 09:10am
<b>12<sup>th</sup> Feb</b>	Wed 14 <sup>th</sup> : Parents' Evening 3:30pm-5:30pm Thurs 15 <sup>th</sup> : Parents' Evening 4:30pm-7:00pm
<b>19<sup>th</sup> Feb</b>	Half-Term
<b>26<sup>th</sup> Feb</b>	Mon 26 <sup>th</sup> : Children back Thurs 1 <sup>st</sup> : World Book Day
<b>5<sup>th</sup> March</b>	Fri 9 <sup>th</sup> : Mother's Day afternoon tea and activities (pm)
<b>12<sup>th</sup> March</b>	Thurs 15 <sup>th</sup> : Family learning morning Fri 16 <sup>th</sup> : 3A Class Assembly at 09:10am
<b>19<sup>th</sup> March</b>	Fri 23 <sup>rd</sup> : 3B Class Assembly at 09:10am
<b>26<sup>th</sup> March</b>	Mon 26 <sup>th</sup> : Year 3 go on residential – 3 days Thurs 29 <sup>th</sup> : Last day of term Fri 30 <sup>st</sup> : School Closed for Easter Holidays
<b>2<sup>nd</sup> April</b>	Easter Holidays
<b>9<sup>th</sup> April</b>	Easter Holidays
<b>16<sup>th</sup> April</b>	Mon 16 <sup>th</sup> : Children start back at school 8:45am start